

# LORIEN



## **LORIEN -TIMELESS DESIGN, MODERN PERFORMANCE**

The LORIEN luminaire is a highly adaptable solution that combines timeless aesthetics with advanced performance. Designed for public spaces, it ensures uniform, glare-free illumination, enhancing visibility and ambiance in residential areas, parks, squares, and parking lots.

# LORIEN



Description	Value
Housing	Aluminium
Cover	Polycarbonate
CRI (K)	3000, 4000
Optics	Diffuser
Driver	Tridonic
Surface protection	Powder coating
Lifetime (h)	100000
Power factor	0,95
Surge protection SPD	6-8kV
Delivered with Cable	Yes - length on demand
Color housing (RAL)	9006 (Gray)
Degree of protection (IP)	IP66
Impact strength (IK)	10
Protection class	II
Length (mm)	553
Width (mm)	553
Height (mm)	447
Netto weight (kg)	7,5
Wind area (m <sup>2</sup> )	0,34
Ta° Temperature	-40...50 °C

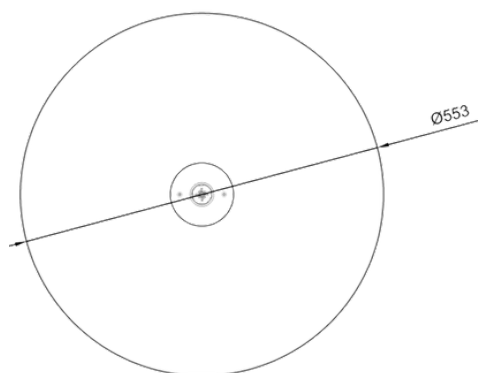
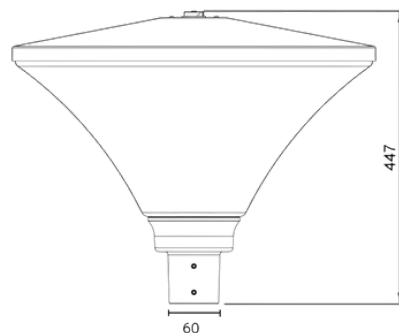

# LORIEN



Name	Luminous flux (lm)	Power (W)	Efficiency (lm/W)	Standard CCT (K)
PRK 35 DPC 840	4060	35	116	4000
PRK 35 DPC 830	3850	35	110	3000
PRK 25 DPC 840	3150	25	126	4000
PRK 25 DPC 830	3000	25	120	3000

## Key Features:

- Superior Optical Performance - Diffuser optics ensure uniform and glare-free illumination for public spaces.
- Long Operational Life - Engineered for 100,000 hours of operation, minimizing maintenance needs.
- Durable and Impact-Resistant - IK10-rated polycarbonate cover for high-impact resistance.
- Weatherproof Construction - IP66-rated protection ensures durability in various environmental conditions.
- Flexible Mounting Options - Designed for post-top mounting with 60mm or 108mm spigot compatibility.
- Advanced Driver Technology - Equipped with a CLO driver, compensating for natural LED depreciation over time.
- Smart Integration - Optional Zhaga Book 18 socket for future-ready connectivity and smart lighting controls.
- Sustainable Design - Fully modular construction, allowing for easy replacement of key components.
- Eco-Conscious Packaging - 100% recyclable, plastic-free corrugated cardboard packaging.